

KIT PRICE*
£149.99

***Full Kit Includes:**
Master Lock, Slave Lock,
4 x Shootbolts, 2 x Twin Keeps,
2 x 40/40 Keyed Alike Cylinders and
two pairs of Windsor Door Handles
(standard finishes only)

Ventas Door Lock - Twin Handle System

The Ventas French Door Locking System was designed by Westward and produced specifically for the UK joinery industry.

The knowledge that we have gained from the various problems that multi-point locks can cause prompted us to create a solution. We believe this product will benefit you with ease of manufacture and limit the amount of remedial issues that you may encounter.

First and foremost we have incorporated tapered linear bolts instead of hooks. Hooks can cause catching problems when doors shrink; they grind against the back of the keep which in turn transfers wear to the gearbox. This in time leads to lock failures and the hooks not being able to fully engage into the slave lock, which can require expensive site visits and remedial costs.

One of the main issues with timber French doors are the varying heights needed. With this in mind we have designed the Ventas lock to accommodate very short door heights and taller doors that are beyond the industry standard of 2.1 metres. We have tackled this problem by designing a door lock that has a low top deadbolt.

This when accompanied with a shoot bolt can achieve a fully engaged door of 1870mm with a handle height of 1050mm. If your door is shorter than this, consider moving the handle height to 950mm achieving a door rebate height of 1770mm. If your door is any shorter then remove the top shoot bolt from the system and a door height of 1600mm can be achieved.

On taller doors we have come up with an ingenious idea of putting an extra locking point within the extension. This enables you to reach any height door but with the benefit of having an extra locking point to help with compression and security of both stiles. This will minimise the risk of the door wanting to twist and come away from the rebate.

The master door bolt has the benefit of being used in conjunction with our TDK range of keeps to achieve a very secure single door that will pass the current PAS24 test and help limit the amount of stock and products you require.

This system has achieved PAS24 certification from an approved UKAS test house. This test is available to you and your company at very competitive rates, please contact us to discuss your requirements. Please take some time to look through all the key features and Technical Details, and contact us if you require any further information or assistance.

FULL KIT PRICES INCLUDES:
MASTER LOCK, SLAVE LOCK, 4 X SHOOTBOLTS AND
2 X TWIN HOLE ADJUSTABLE SHOOTBOLT STRIKES

10+
£84.99

5+
£87.99

1+
£89.99

VENTAS DOOR LOCK SYSTEM

OPTION 1

LOCKING SYSTEM FOR
SINGLE REBATED DOORS

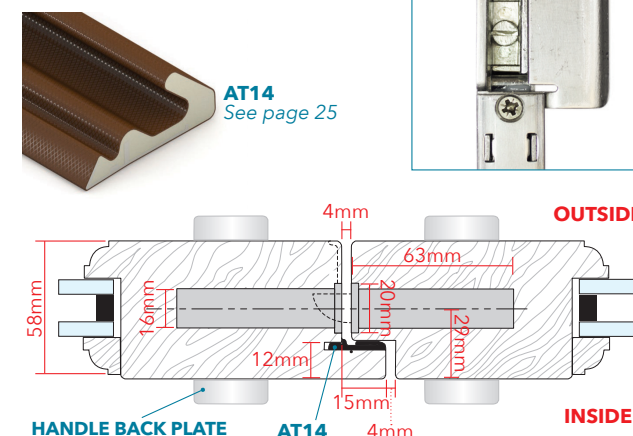

OPTION 2

LOCKING SYSTEM FOR
DOUBLE REBATED DOORS

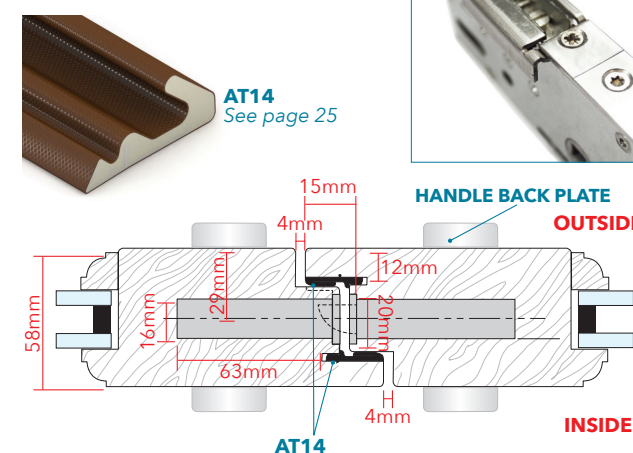

OPTION 3

LOCKING SYSTEM FOR
SQUARE EDGE DOORS

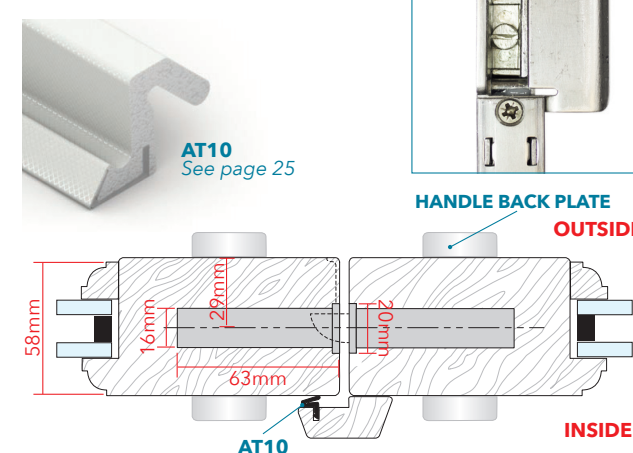

TDK VCK - VENTAS ONE PIECE KEEP

FOR **SINGLE** DOORS

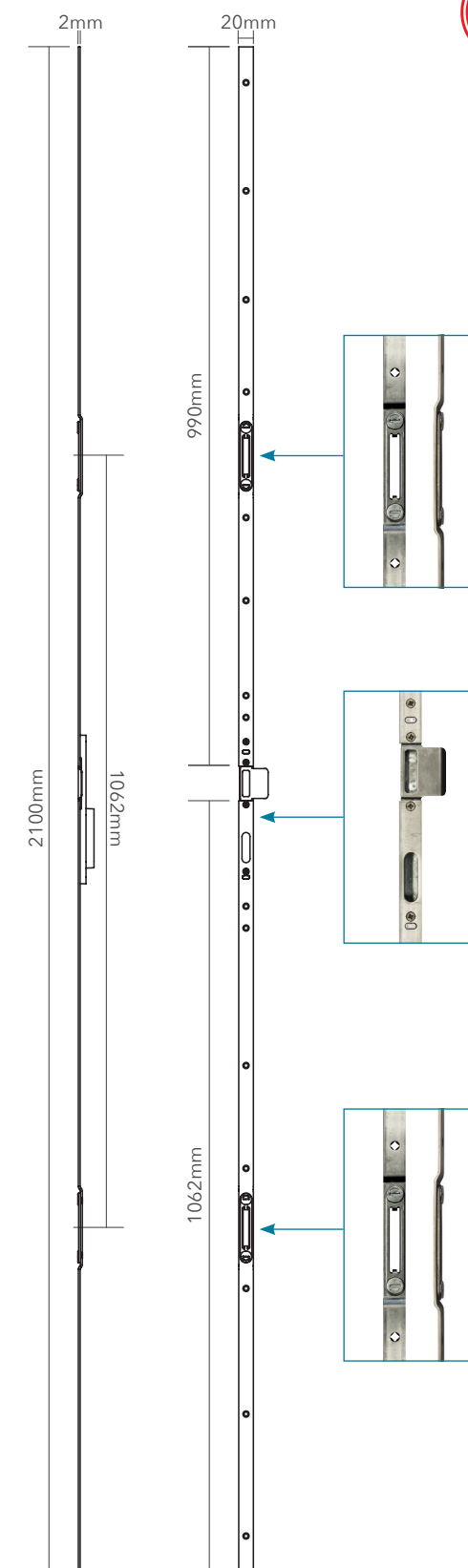

FROM
£16.99

10 YEARS

240 HOURS

50,000 CYCLES

1-4
£21.99

5-9
£18.99

10+
£16.99

THESE DRAWINGS ARE JUST AN EXAMPLE. WESTWARD TAKE NO RESPONSIBILITY ON THE FAILING OF JOINERY BASED ON THESE DRAWINGS.

VENTAS DOOR LOCK SYSTEM

- KEY FEATURES
- ✓ 3 x 20mm brass forged tapered deadbolts opposed to hooks for a remedial free product
 - ✓ Full adjustment on every locking point
 - ✓ Extension incorporating deadbolt (MASTER) and adjustable keep (SLAVE) for taller doors
 - ✓ Lever lock mechanism for master and slave door for ease of use
 - ✓ Double laminated security shootbolts on slave and master doors to give added security
 - ✓ 45mm backset for slave and master lock for easy sash preparation
 - ✓ Adjustable strike plates designed to finish flush with 20mm face plate so the product doesn't sit proud of edge of the door
 - ✓ Face plate and drive bar manufactured from Stainless Steel
 - ✓ Both locks split spindle on same spindle as standard
 - ✓ Bi-directional gearbox operation
 - ✓ Anti-fouling device fitted to slave lock ensuring you have to lock master before locking slave door
 - ✓ Built in independent latch strike set for centering of 56 - 58mm doors
 - ✓ 1870mm min height with handle height of 1050mm for fully shot French doors, can be used for shorter doors if reducing handle height or not fitting top shoot bolt
 - ✓ PAS24 accredited, for single and French doors. If you are interested in achieving PAS24 or equivalent EN please contact sales office
 - ✓ Adjustable range of single door keeps for 44mm and 56mm doors, fully pocketed, adjustable single or double shootbolt keeps
 - ✓ Non-handed

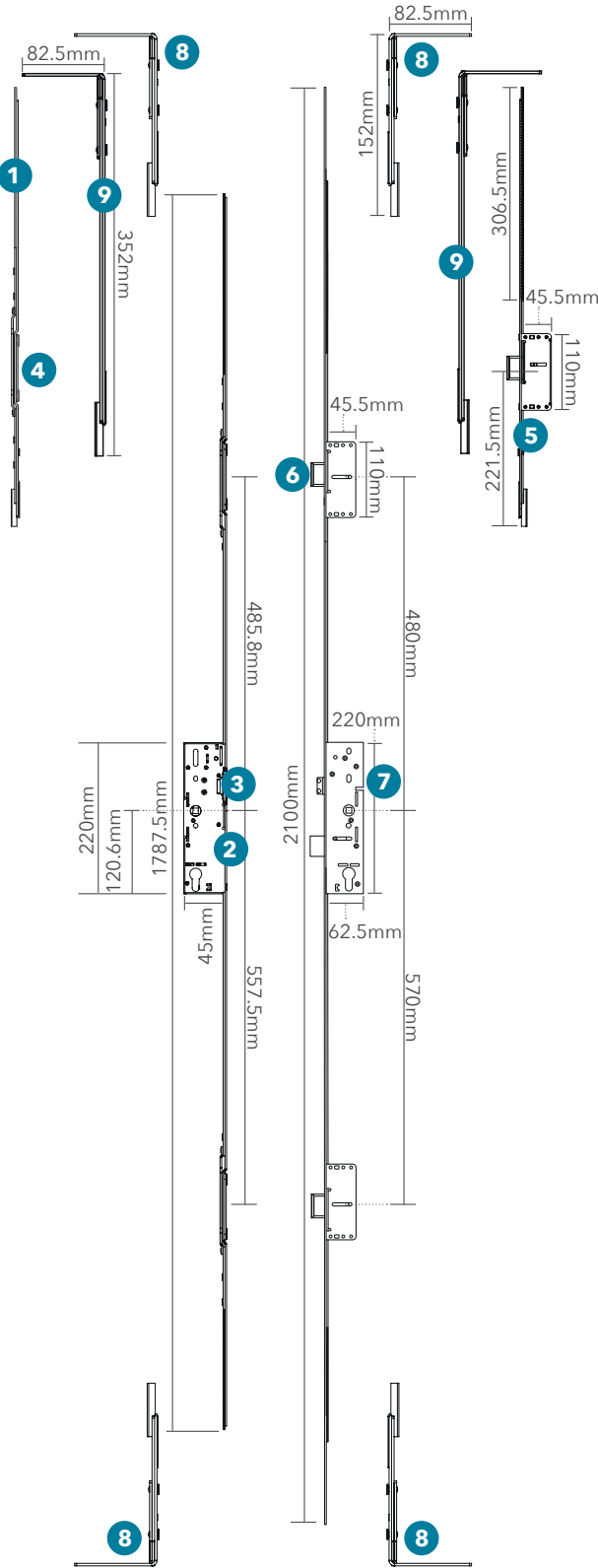

FOR SINGLE DOORS

The TDK Single Shootbolt keep is eccentric in its adjustment and is probably the best available option for securing the shootbolt into aluminium or timber thresholds.

See page 106 for pricing & Twin Shootbolt Keep

FOR DOUBLE DOORS

The MWK Striker Block is an extruded aluminium striker block for use with double door applications.

See page 28 for pricing

Picture is for illustration purposes only

VENTAS DOOR LOCK SYSTEM

- 1 Slave Extension

TDKASEX

600mm Slave Extension with integral adjustable keep to accept master extension.
- 2 Latch Strike

Adjustable centre Latch Strike to suit a centre lock position on a 56mm door. On thicker doors use an offset lock. Alternatively enquire with the sales team about a bespoke latch strike.
- 2 Rebate Latch Strike

TDKVRK

Keep designed for rebated stiles. Please refer to profile drawing option 2 on Page 89.

Sold separately.
- 3 Anti-Foul Device

Feature that ensures slave lock must be thrown before master lock is secured.
- 4 Deadbolt Strike

Fully adjustable flush deadbolt strikes with +/- 2mm of adjustment.
- 5 Master Extension

TDKAMEX

600mm Master Extension with integral high security forged brass linear bolt.
- 6 Tapered Deadbolt

2 x high security forged linear bolts with 22mm throw and a tapered lead in.
- 7 Split Spindle Option

Master lock has a split spindle option as standard, with a snib facility for de-latching.
- 8 Double Laminated Shootbolt

TDKACS2

Extra enhanced security shootbolt for improved resistance to forced entry.
- 9 Extended Shootbolt

TDKVTSBEX

To use on doors with heights between 2100mm and 2280mm. Also double laminated.

PLEASE STATE SASH REBATE SIZE WHEN ORDERING AND WE WILL WORK OUT THE COMPONENTS YOU REQUIRE

ORDER ONLINE

www.westwardbuildingservices.com

We have made it easier for you to order online! You can now buy full kits through our website! Just use the drop-down menu to choose the kit you require.